



**JADE 959**  
JADE YACHTS  
51.8M-2014























































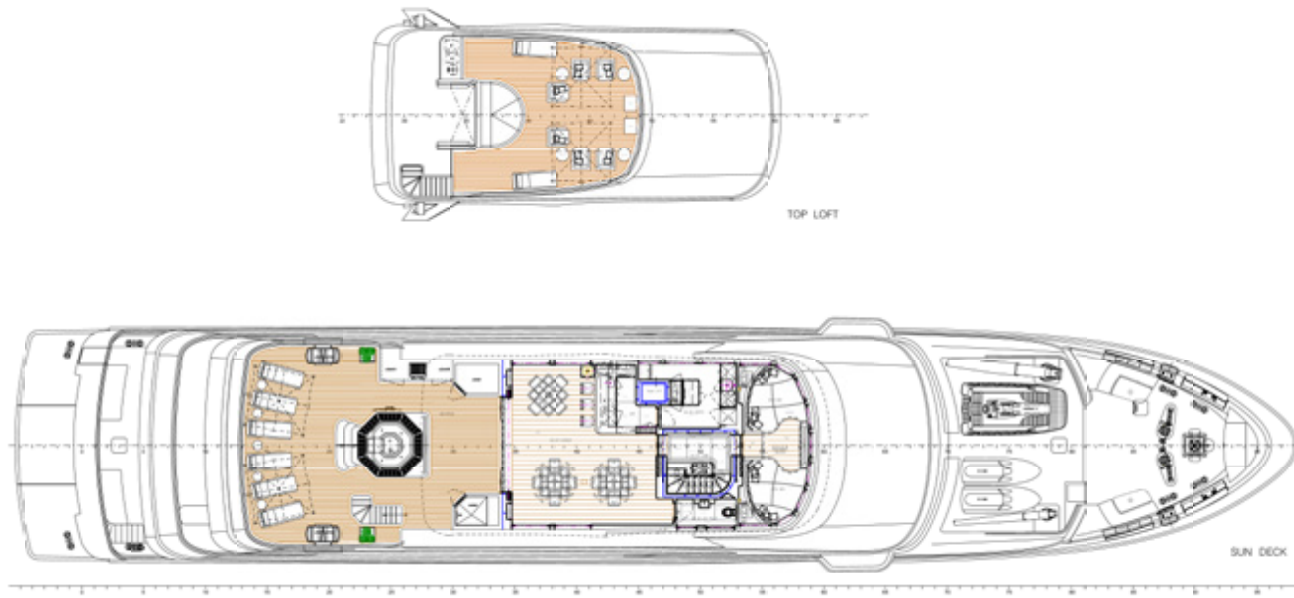

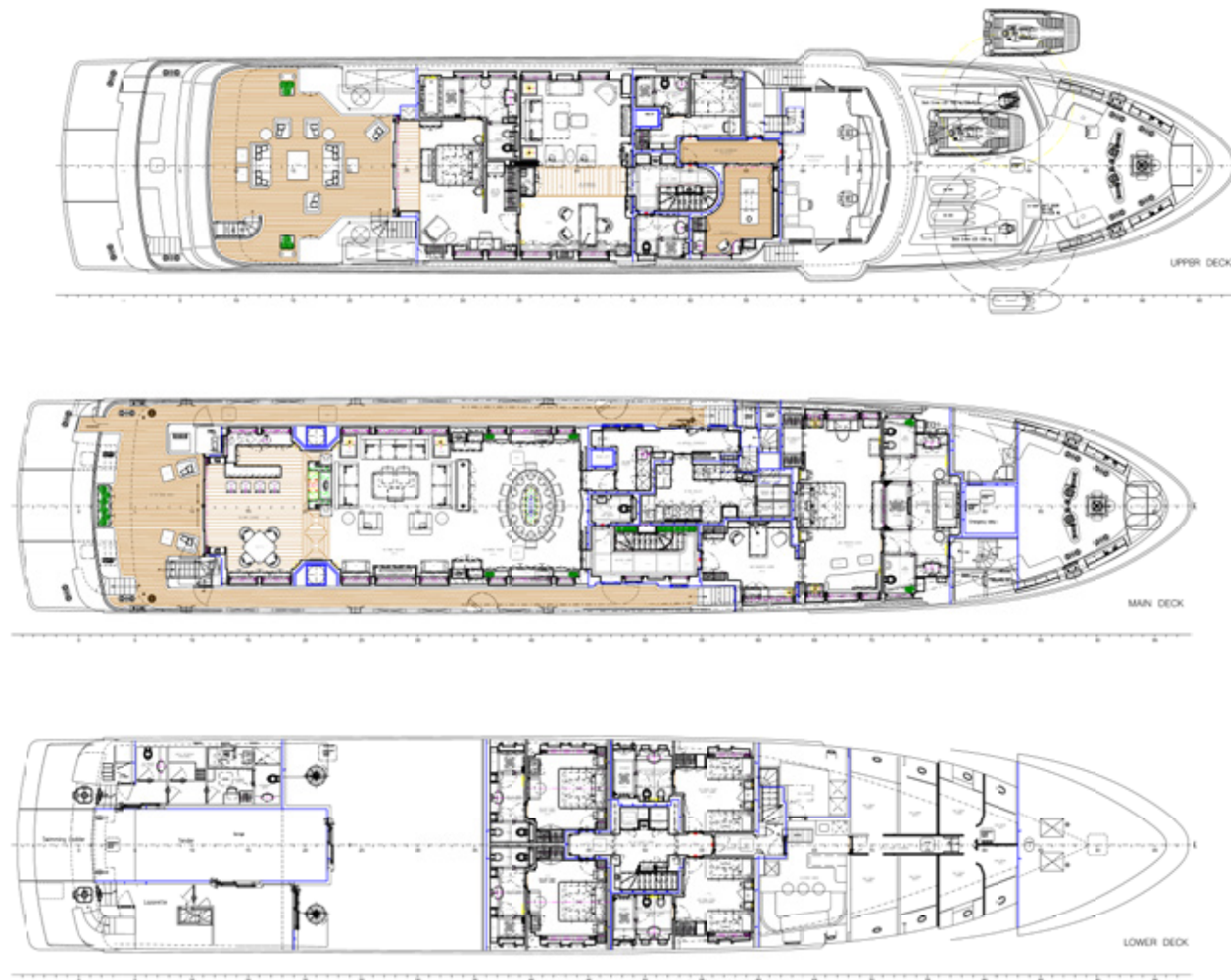

## OVERVIEW

Name	Jade 959
Type	Motor Yacht
Model	Custom
Builder	Jade Yachts
Naval Architect	Jade Yachts
Exterior Designers	Espinosa Yacht Design
Interior Designer	-
Year	2014
Flag	Cayman Islands
MCA	-
Class	-
Hull NB	170/001
Hull Colour	-



## DIMENSIONS

Length Overall	51.80m (169'11"ft)
Length at Waterline	-
Beam	9.40m (30'10"ft)
Draft (min)	-
Draft (max)	3.07m (10'0"ft)
Gross Tonnage	780 tonnes

## ACCOMMODATIONS

Guests	12
Cabins Total	6
Cabins	4 Double / 2 Twin / 2 King 2 Double / 4 Single
Crew	9

## CONSTRUCTION

Hull Configuration	Displacement
Hull Material	Steel
Superstructure	Aluminium
Deck Material	-
Decks NB	-

## PERFORMANCE & CAPABILITIES

Max Speed	-
Cruising Speed	11.00 kts
Fuel cons.	350 Litres/Hr
Fuel Capacity	-
Water Capacity	-

## ENGINE(S)

Quantity	-
Fuel Type	-
Manufacturer:	-
Model	MTU 16V 4000 M61 2682 HP CAT C9 200kw x 2 sets CAT C4.4 82kw x 1 set

## EQUIPMENT

**Tenders + Toys** 6.25m Williams Tender, 4.5m Rescue boat  
4.2m Crew Tender, 5 x Seadoo Jet Skis, 10 x Sets dive equipment,  
1 x Air compressor, 1 x Water Ski, 2 x Wakeboard, 2 x Canoe, 2  
x Paddle, 1 x Water Walking Ball, 1 x Inflatable Water Sofa, 1 x  
Inflatable Water Donut



